

RLC-1212A

Smart 12MP Ultra HD Plug & Play PoE Camera

- Person/Vehicle Detection
- 12MP Ultra HD
- Color Night Vision



Specifications

Video & Audio	
Image Sensor	1/2.49" CMOS Sensor
Video Resolution	4512×2512 (12 Megapixels) at 20 fps
Lens	f=4.0mm; F=1.6, with IR-cut filter
Video Format	H.265/H.264
Field of View	Horizontal: 97°; Vertical: 50°
Day & Night	Auto-switching with IR-cut filter
Infrared Night Vision	30 meters (100ft) (LED: 2pcs/28mil/850nm)
Color Night Vision	Spotlight: 1pc/4.3W/6500K/700 Lumens
Audio	Two-way audio
Power	
PoE	IEEE 802.3af, 48V Active
DC Power	DC 12.0V 1A, <12W
Interface	
Power	DC power port

System	Reset button
Ethernet	One 10M/100Mbps; RJ45
Storage	Micro SD card slot (Max. 512GB)
Audio	Built-in microphone and speaker
Software Features	
Frame Rate	Mainstream: 2fps - 20fps (default: 20fps); Substream: 4fps - 20fps (default: 10fps)
Code Rate	Mainstream: 3072Kbps - 10240Kbps (default: 8192Kbps); Substream: 128Kbps - 1024Kbps (default: 768Kbps)
Browsers Supported	Edge, Chrome, Firefox, Safari
OS Supported	PC: Windows, Mac OS; Smartphone: iOS, Android
Smart Alarm	Motion detection/person detection/vehicle detection/ pet detection
Record Mode	Motion-triggered recording (default); scheduled recording; 24/7 recording
Protocols & Standards	HTTPS, SSL, TCP/IP, UDP, HTTP, IPv4, UPnP, RTSP, RTMP, SMTP, NTP, DHCP, DNS, DDNS, FTP, P2P
Maximal User Access	20 Users (1 admin account & 19 user accounts); support up to 12 simultaneous video streams (10 substreams & 2 mainstreams)
Work with	Google Assistant
Working Environment	
Temperature	Operating temperature: -10°C~+55°C (14°F~131°F)
Humidity	Operating humidity: 10% ~ 90%
Weatherproof	IP67
Size & Weight	
Dimension	Φ67*187mm
Weight	460g
Warranty	
Limited Warranty	2-year limited warranty. For support, visit https://support.reolink.com/hc/en-us/

Gallery & Specs



1. Mount
2. Speaker
3. Metal Aluminum Case
4. Spotlight
5. IR LEDs
6. High Definition Lens
7. Daylight Sensor
8. Built-In Mic

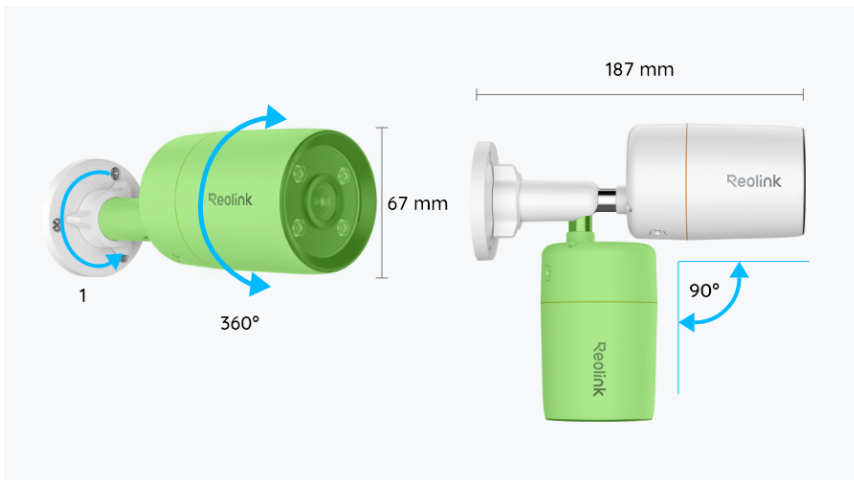

1. Unscrew it (counterclockwise) to loosen the bracket and adjust the camera in any direction.
2. After adjustment, twist it back to fix the camera.



1. micro SD Card Slot

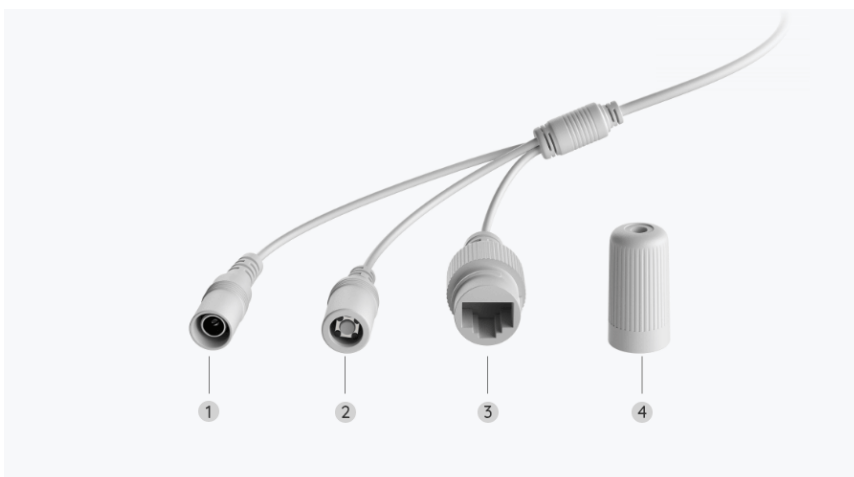

1. Power
2. Reset Button
3. Network
4. Waterproof Lid

